

IEM-ATOM

ETX 3.0 CPU Module with Intel® Atom™ Processor, VGA/LVDS, LAN, SATA, USB and Audio

ETX 3.0

DDR2 533Mhz support up to 2GB Intel® Atom™ N270

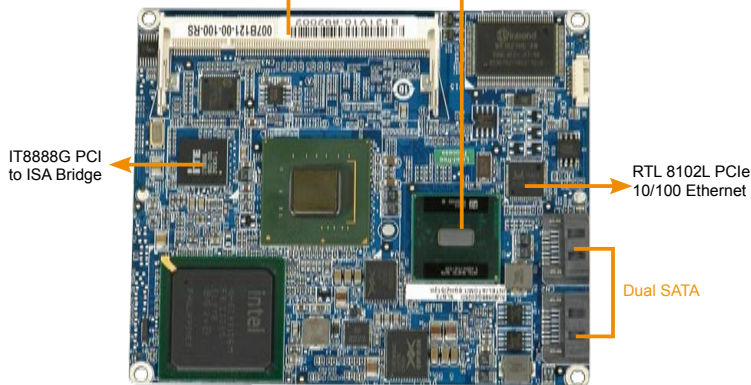

Ship with Heat spreader only

IEM-ATOM ETX 3.0 Module with IEM-DB-7S ETX Base board

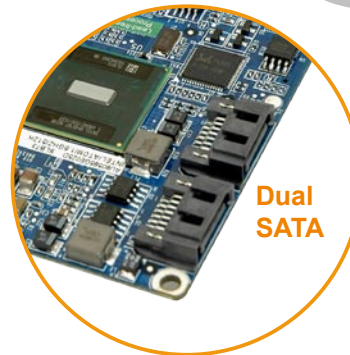

Dual
SATA

Features

1. ETX 3.0 CPU Module with on board dual SATA-150 ports
2. Support 4x PCI, 1x ISA Slot for expansion
3. Support Dual Display for VGA + LVDS
4. Support 4x USB2.0, 2x SATA, 1x IDE Interface



Solder Side



Specifications

- ◆ CPU
Intel® Atom™ Processor N270 1.6GHz with a 533MHz FSB
- ◆ System Chipset
Intel® 945GSE + Intel® 82801GBM/ICH7M
- ◆ BIOS
AMI
- ◆ System Memory
One 200-pin 533/400MHz DDR2 SO-DIMM supported (system max. 2GB)
- ◆ Ethernet
One 10/100Mbps Realtek RTL8102E Ethernet Chipset (PCIe Interface)
- ◆ Super I/O
ITE IT8718
- ◆ IO Interface
4 x USB 2.0 (to Base Board)
2 x SATA (On CPU Module)
1 x IDE (to Base Board)
1 x LPT (to Base board)
2 x RS-232 (to Base board)
1 x PS2 KB/MS (to Base board)
- ◆ Expansion
4 x PCI, 32 bit / 33 MHz PCI bus to Base Board
ISA support by ITE IT8888G
- ◆ Display Interface
VGA/TV-Out Integrated in Intel 945GSE Signal (to Base Board)
18-bit Dual channel LVDS Signal (to Base Board)
- ◆ Watchdog Timer
Software programmable supports 1 ~255 sec. System reset
- ◆ Power Supply
AT / ATX supported
- ◆ Power Consumption
5V@2.9A (Intel® Atom™ N270 with 1GB DDR2)
- ◆ Temperature
Operation: 0°C ~ 60°C (32°F ~ 140°F)
- ◆ Humidity
Operation: 5% ~95% non-condensing
- ◆ Dimensions
115 mm x 95 mm
- ◆ Weight
GW: 600g NW 250g

Mechanical drawing

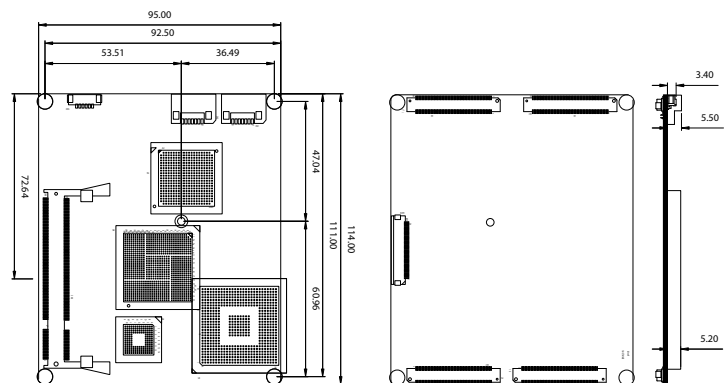

Packing List

1 x IEM-ATOM Single Board Computer
1 x Heatspreader
1 x Utility CD
1 x QIG

Ordering Information

Part No.	Description
IEM-ATOM-N270-R10	ETX 3.0 Module with Intel® Atom™ N270 1.6G, VGA/LVDS, LAN, USB, SATA and Audio
IEM-DB-7S-RS-R30	ATX size 7 slots ETX Baseboard
34000-000180-RS	Heatsink for ETX 3.0 Module